

# BR-2010A parameter

Revision date: 12/04/2022

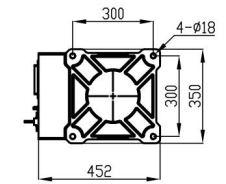

VIEW A

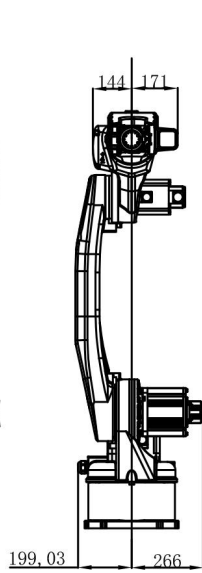
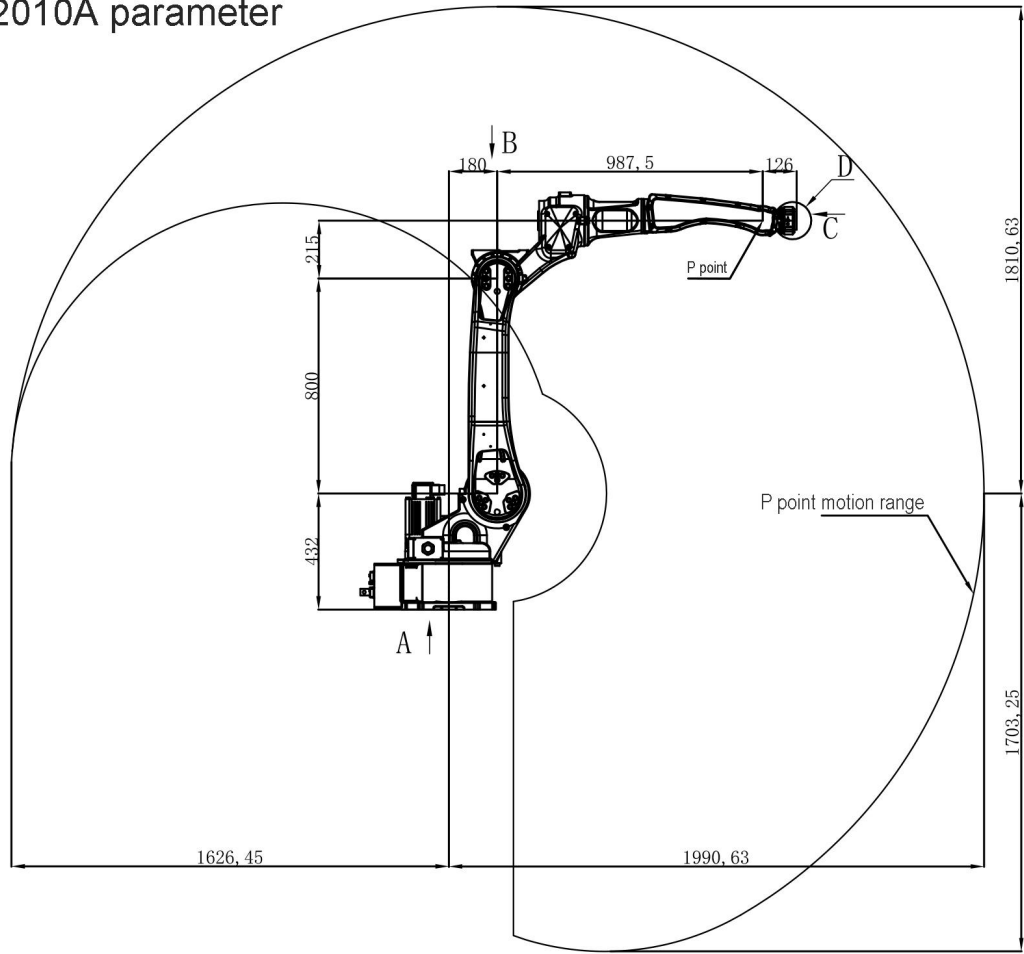
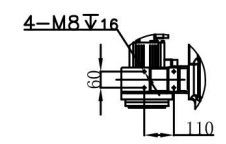

VIEW B

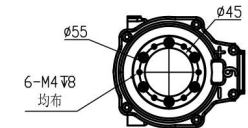

VIEW C

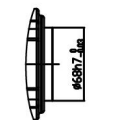

VIEW D

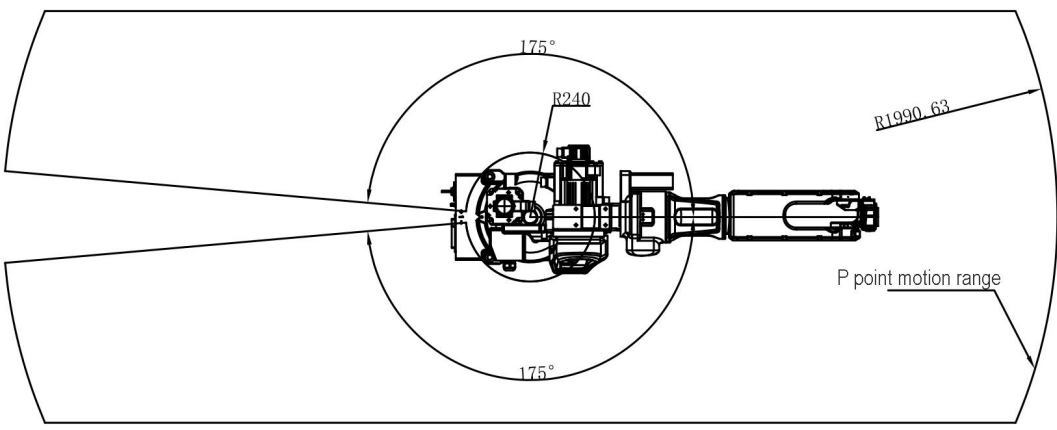
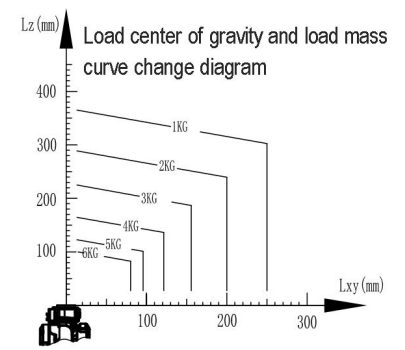

|                  |               |                     |                                      |                 |              |    |           |
|------------------|---------------|---------------------|--------------------------------------|-----------------|--------------|----|-----------|
| Model            | BR-2010A      | Motion Range        | J1                                   | $\pm 175^\circ$ | Motion Speed | J1 | 172.1° /s |
| Axis             | 6             |                     | J2                                   | +85° ~ -150°    |              | J2 | 135.1° /s |
| Reach(about)     | 2000mm        |                     | J3                                   | $\pm 80^\circ$  |              | J3 | 259.3° /s |
| Max Payload      | 6KG           |                     | J4                                   | $\pm 150^\circ$ |              | J4 | 294.1° /s |
| Repeatability    | $\pm 0.08$ mm |                     | J5                                   | +130° ~ -105°   |              | J5 | 294.1° /s |
| Power Capacity   | 3KVA          |                     | J6                                   | $\pm 220^\circ$ |              | J6 | 426.7° /s |
| Protection Class | IP65          | Installation Method | Ground hanging                       |                 |              |    |           |
| Robot Weight     | 230KG         | Use Environment     | 0-45°C, 20-80%RH(No condensation)    |                 |              |    |           |
| Function         | Welding       | Input Voltage       | Single-phase 220V $\pm 10\%$ 50/60Hz |                 |              |    |           |